

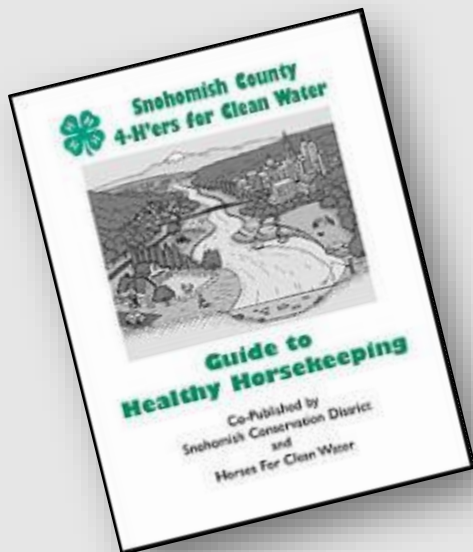

# Alayne Blickle & Horses for Clean Water



- Classes, farm tours, workshops, educational materials, individual consultations
- Environmentally friendly ways of keeping livestock





# Why “Clean Water?”

Runoff from:

- muddy livestock properties
- over-grazed pastures
- mis-used chemicals
- manure piles



**Causes problems!**





# Problems mud & runoff can create...



- livestock health issues
- decreased owner convenience & chore efficiency
- reduced productivity of property
- increased vet bills
- reduced neighborhood esthetics
- environmental impacts



# What is Horses for Clean Water?

Win-win solutions,  
good for...

- livestock health
- chore efficiency
- farm or ranch productivity
- property esthetics for you (& your neighbors) to enjoy
- save you money
- environmental health





# Pasture Management & Climate Change

Can small acreage  
livestock owners  
make a positive  
impact?



# Climate change models predict:

- Hotter, drier summers
- Warmer winters
- More rain and less snow
- More and longer droughts
- More weather extremes
- Wetter winters and springs





# Climate change is causing:

Melting glaciers and decreasing Arctic sea ice which in turn causes rising sea levels

More severe weather

Beach erosion from increased sea levels, greater winds, and more severe weather

Loss of plant, animal, and insect diversity because of lack of habitat



# Climate changes will cause:

Increasing wild fires

Emergence and spreading of diseases and pathogens; Mosquitoes, ticks, flies, and other pathogens are moving northward as things warm up, putting animals, trees, crops, and humans at risk

Increased crop and agricultural issues

Lack of drinking water





Allan Savory:

# How to fight desertification and reverse climate change

TED2013 · 22:19 · Filmed Feb 2013

33 subtitle languages

View interactive transcript

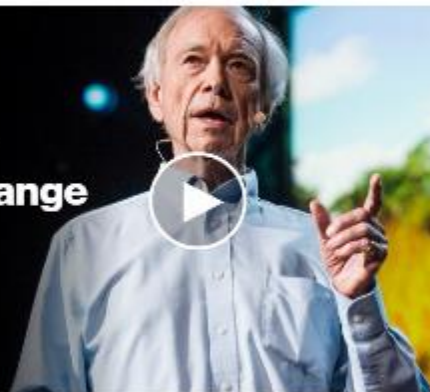

Add to list



Like



Download



Rate

Watch next...  
**Cary Fowler: One seed at a time, protecting the future of food**

Share this idea



3,894,292 Total views

"Desertification is a fancy word for land that is turning to desert," begins Allan Savory in this quietly powerful talk. And it's happening to about two thirds of the world's grasslands, accelerating climate change and causing traditional grazing societies to descend into social chaos. Savory has devoted his life to stopping it. He now believes — and his work so far shows — that a surprising factor can protect grasslands and even reclaim degraded land that was once desert.

Interactive transcript



**Allan Savory**  
Grassland ecosystem pioneer

Allan Savory works to promote holistic management in the grasslands of the world. [Full bio](#)

Playlists to watch

[Browse all](#)

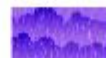













Compost manure & livestock waste and  
apply to pastures

# Advantages of Composting to Livestock Owners

- Kills worm eggs, parasites, pathogens, & weed seeds
- Reduces parasite reinfestation
- Reduces flies
- Reduces odors
- Reduces volume of manure & stall waste by 50%
- Provides you with a free, easy, & very valuable soil amendment

# Advantages of Composting for the Environment

- Helps improve soil health
- Fixes nitrogen ~ better utilized by plants & less water soluble
- Adds micro & macro nutrients
- Adds microbial life ~ beneficial bacteria & fungal organisms
- Acts as a time-released, slow-acting fertilizer
- Helps soil hold moisture better
- Makes plants healthier, more disease resistant





Let's put it all  
together...

# Pasture Management 101

1. Establish a confinement area
2. Manage pastures with rotational grazing
3. Follow the rules of pasture management
4. Small acreage pasture management tools
5. Apply compost

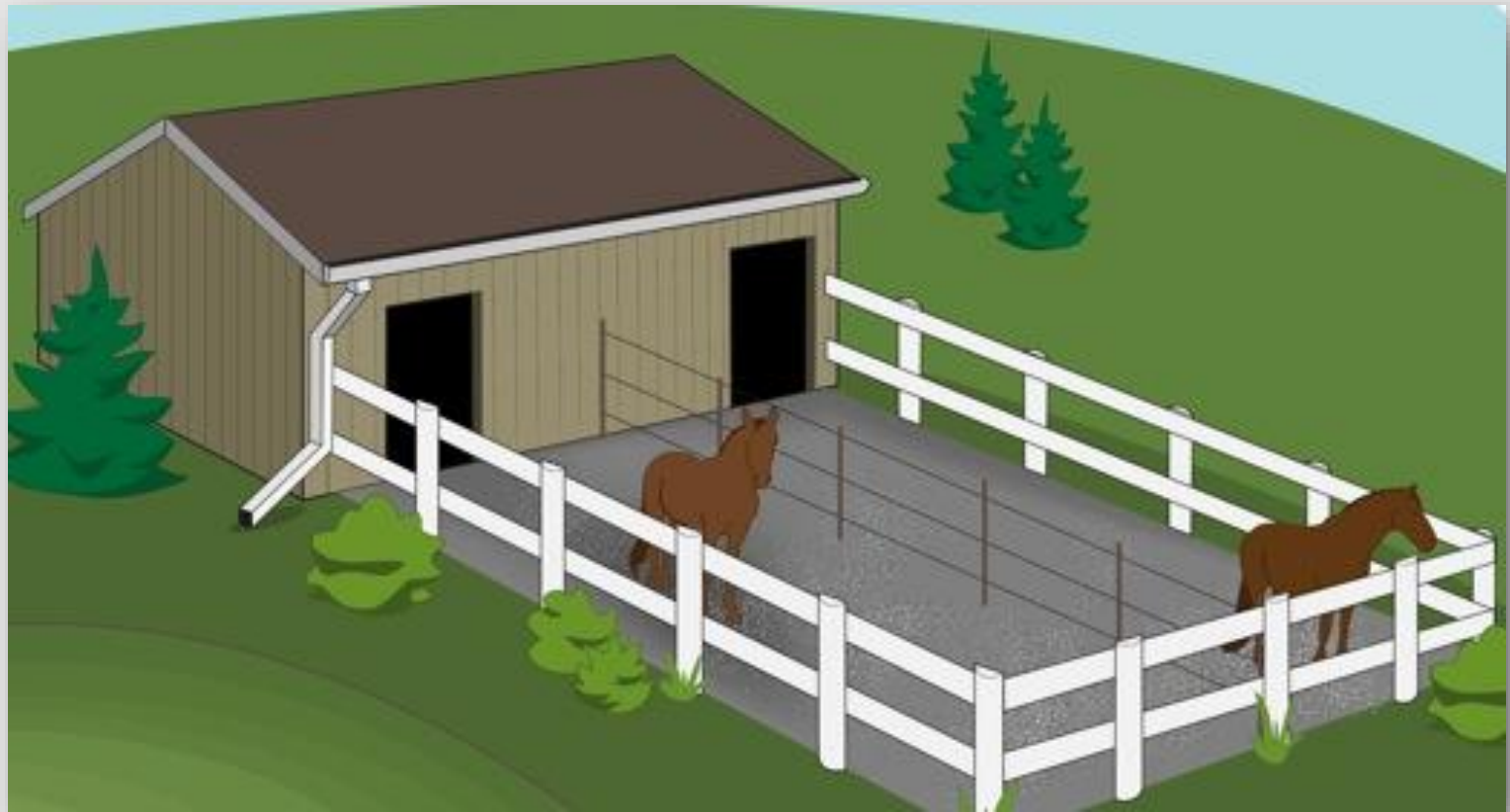

1. Establish a confinement area



A photograph of a horse farm. In the foreground, a brown horse is grazing on a green lawn. In the middle ground, there is a red barn with a brown roof and an open doorway. To the left of the barn, a horse trailer is parked. The background is filled with tall evergreen trees and some deciduous trees with yellowing leaves, suggesting autumn. The sky is overcast. A white text overlay is in the lower-left corner.

Confinement area  
examples...













D3

Shur-Lok





















When to use a  
sacrifice area?











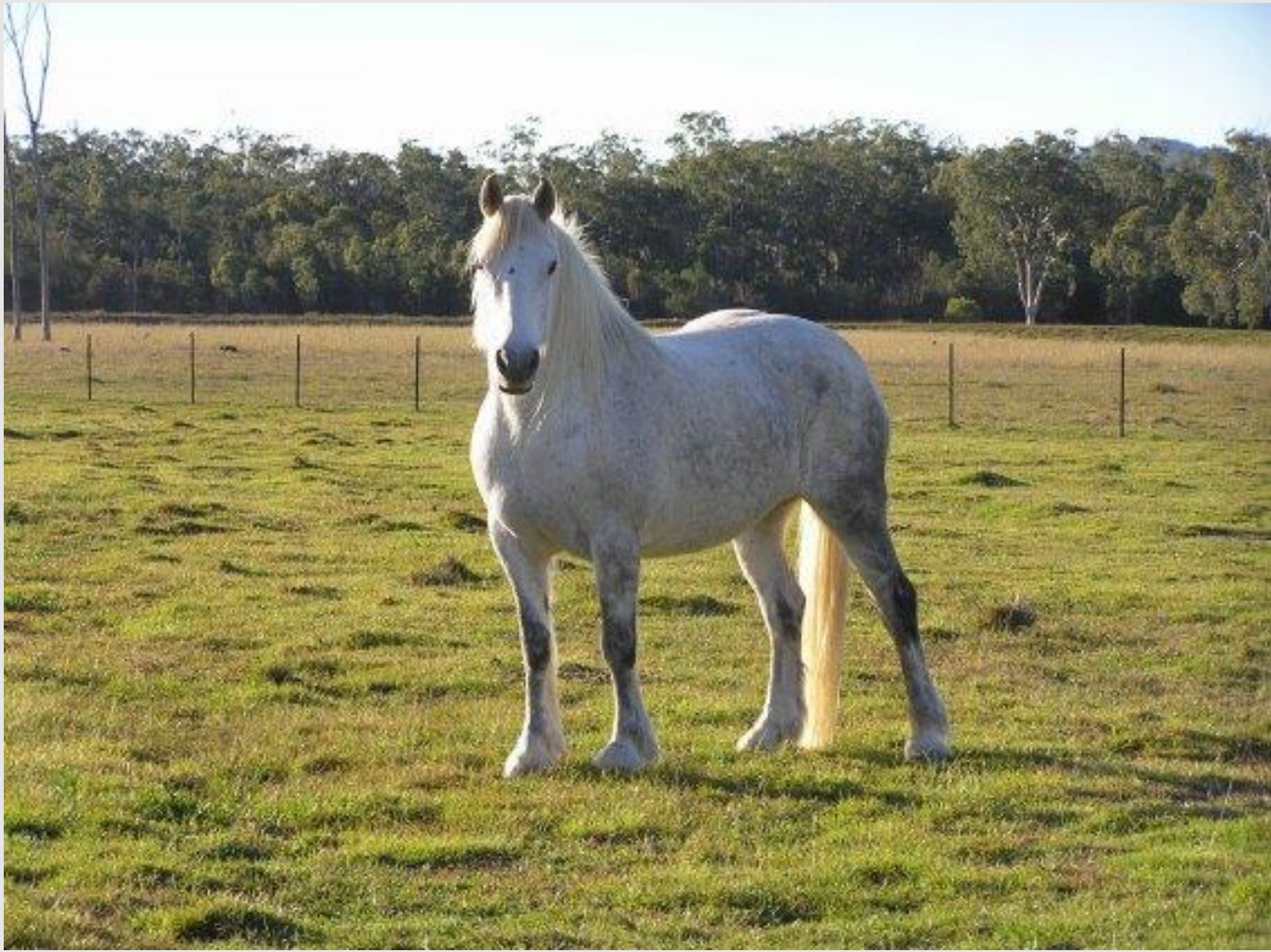



## 2. Manage pastures with rotational grazing system





WINTER  
PADDOCK

SHELTER  
& WATER

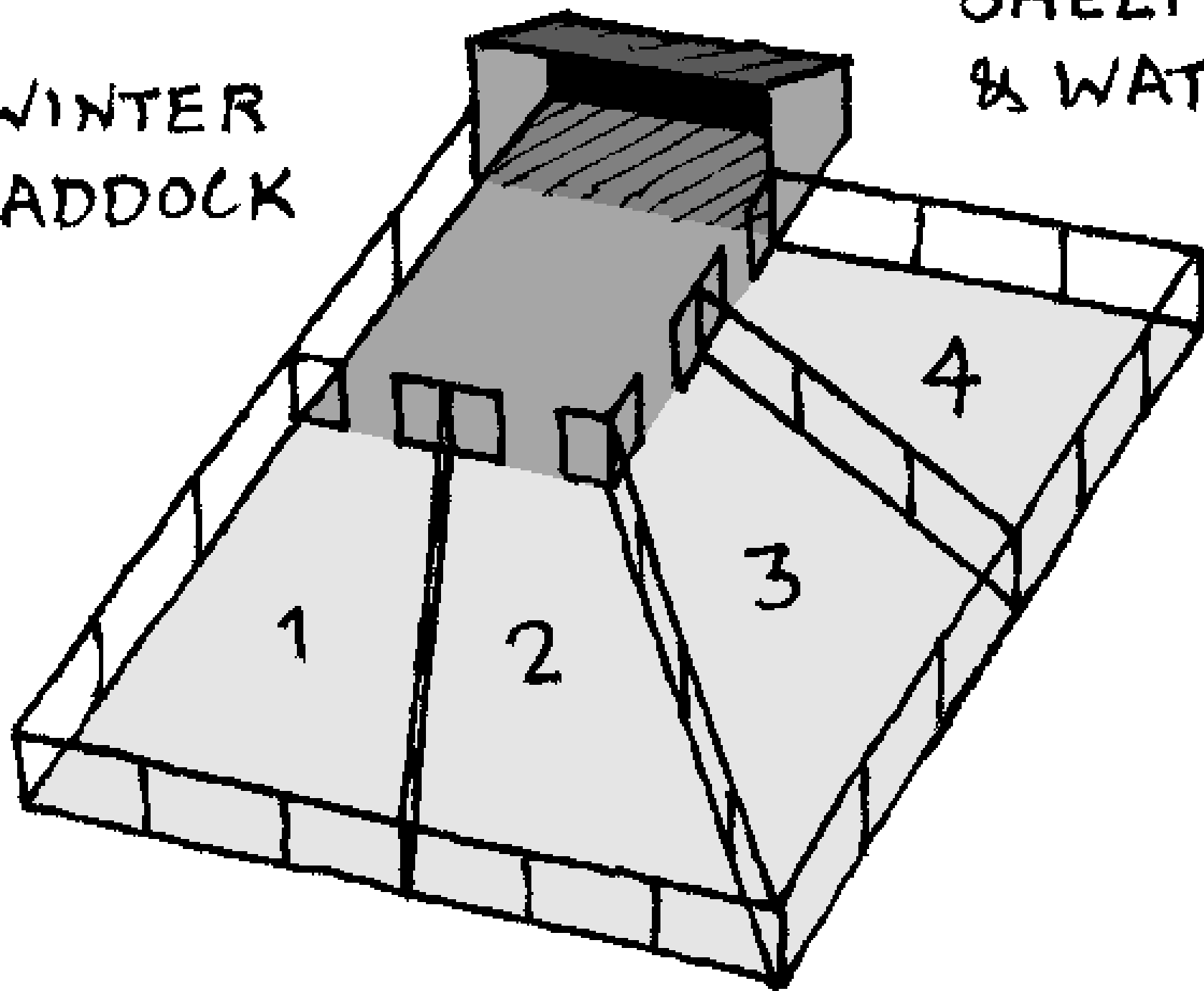

### 3. Rules of pasture management



In the spring begin grazing time gradually,  
about an hour at a time



A photograph of a rural landscape. In the foreground, there is a field of tall, vibrant green grass. In the middle ground, several horses are grazing. On the left, a brown horse is near a wooden fence. In the center, a brown horse and a dark horse are grazing together. On the right, another brown horse is visible. A white fence line runs across the background, behind which is a dense line of green trees. The sky is a clear, pale blue.

Turn livestock out on pasture  
when grass is 6" - 8"





Remove livestock from an area  
once it's grazed to 3" - 4"



A photograph of a rural farm scene. In the foreground, a horse is grazing in a lush green field. A white fence runs along the left side of the frame. In the background, there is a large red barn with a smaller red shed attached to it. A person is standing near the barn. The field is surrounded by trees, including some with pink blossoms. The sky is overcast.

**After you are done grazing an area....  
Mow – harrow – rest**



A dark horse with a blue halter is grazing in a lush green pasture. In the background, two other horses are visible, and a line of tall evergreen trees forms the horizon under a cloudy sky. A white fence runs along the left side of the field.

The **GOLDEN RULE** of pasture management is:

***Never graze below 3 -4 inches!***



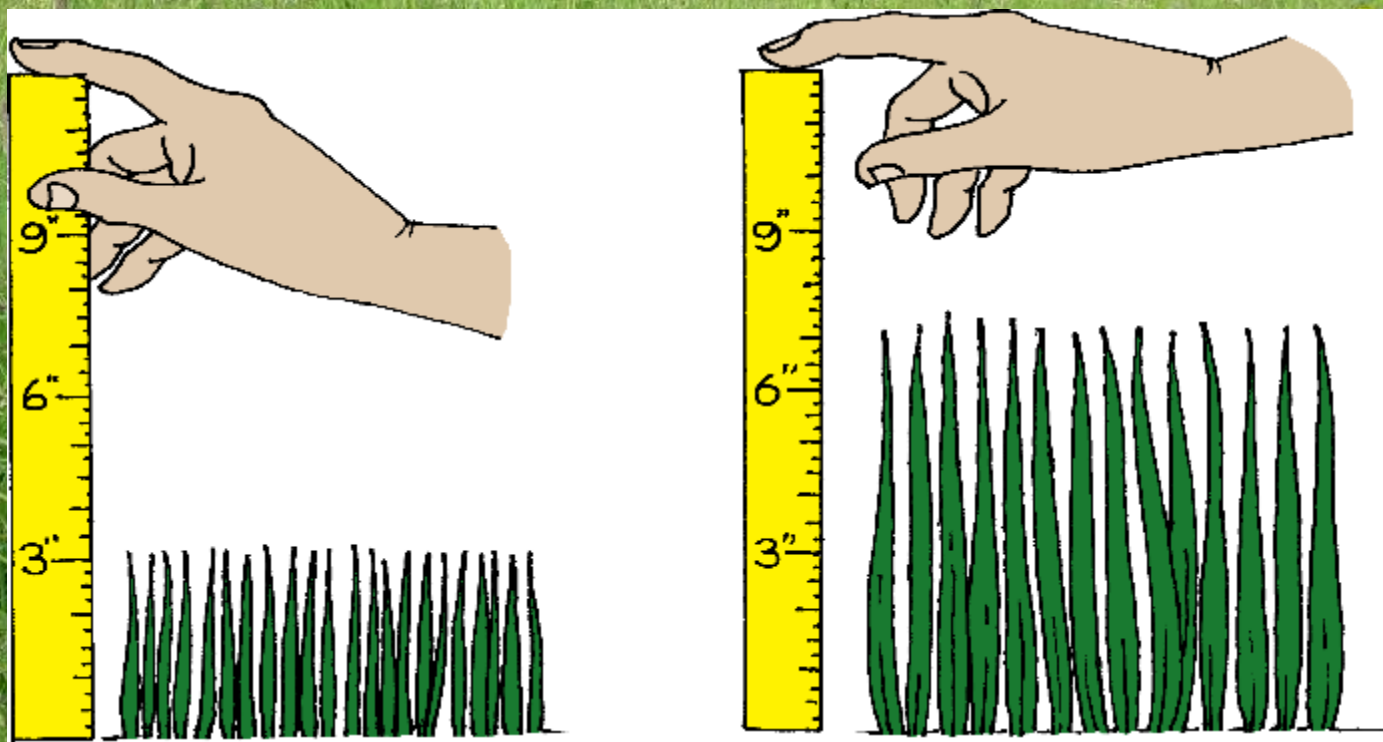
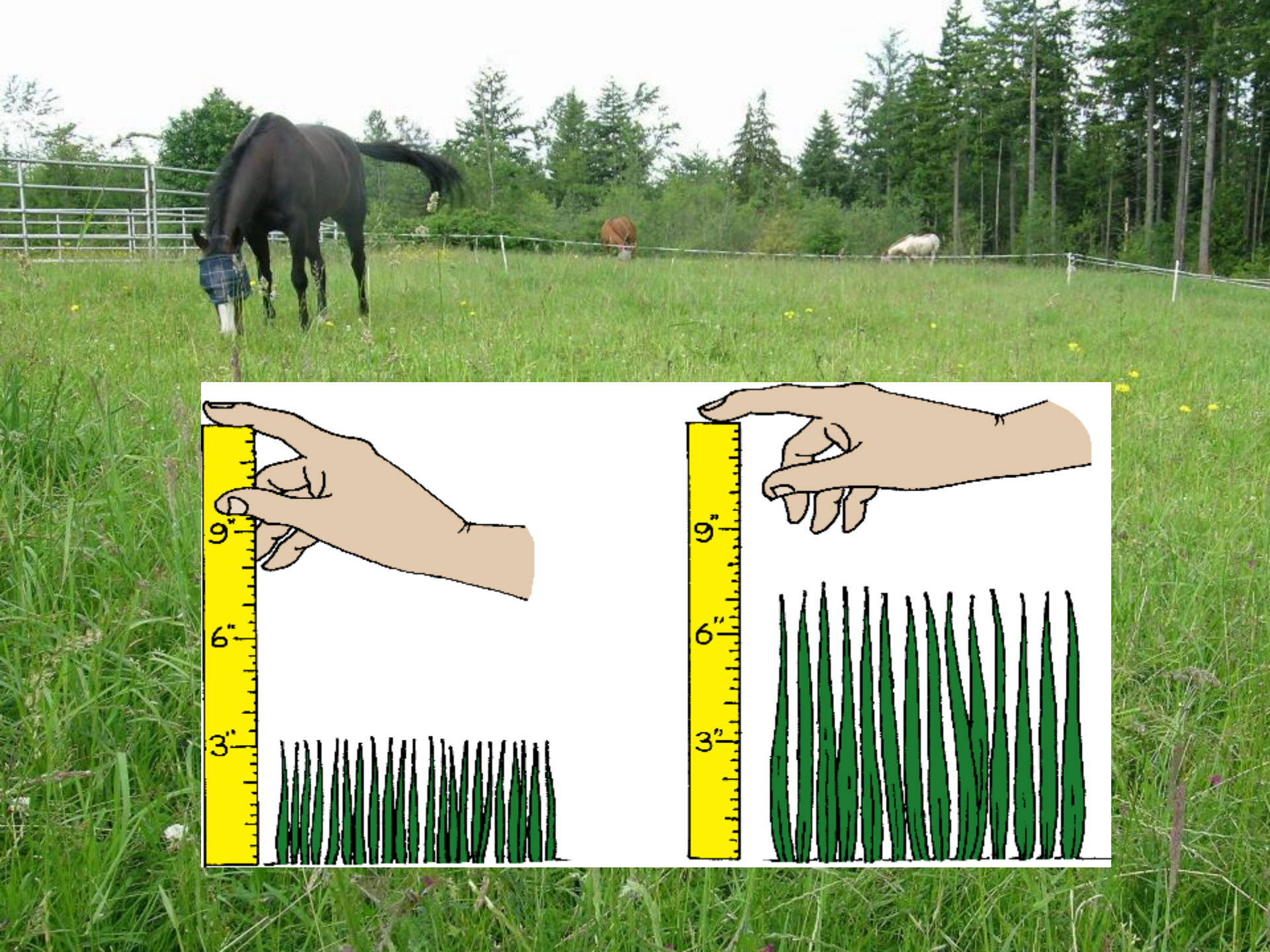



A photograph of a field of tall, green grass with seed heads, likely a meadow or pasture. The grass is dense and reaches up to the text. In the background, there is a line of trees and a small orange object, possibly a person or a piece of equipment, visible on the right side.

Don't allow  
plants to go to  
seed



## 4. Small acreage pasture management tools



# Mowers

A brush hog  
(pasture mower) is  
great -- even a riding  
lawn mower can be  
useful





# Harrows



Tine harrow

Home made  
harrow





A photograph of a grassy field with a white fence in the foreground and background. A single tree stands in the middle ground. In the far background, a horse is grazing. The text "Harrow 'the rough'" is overlaid in the center.

Harrow "the rough"



# 5. Compost Application Guidelines



- Apply to pastures, lawns, gardens
- Apply only during growing season
- Apply about ¼” at a time
- Apply no more than 3-4” per year













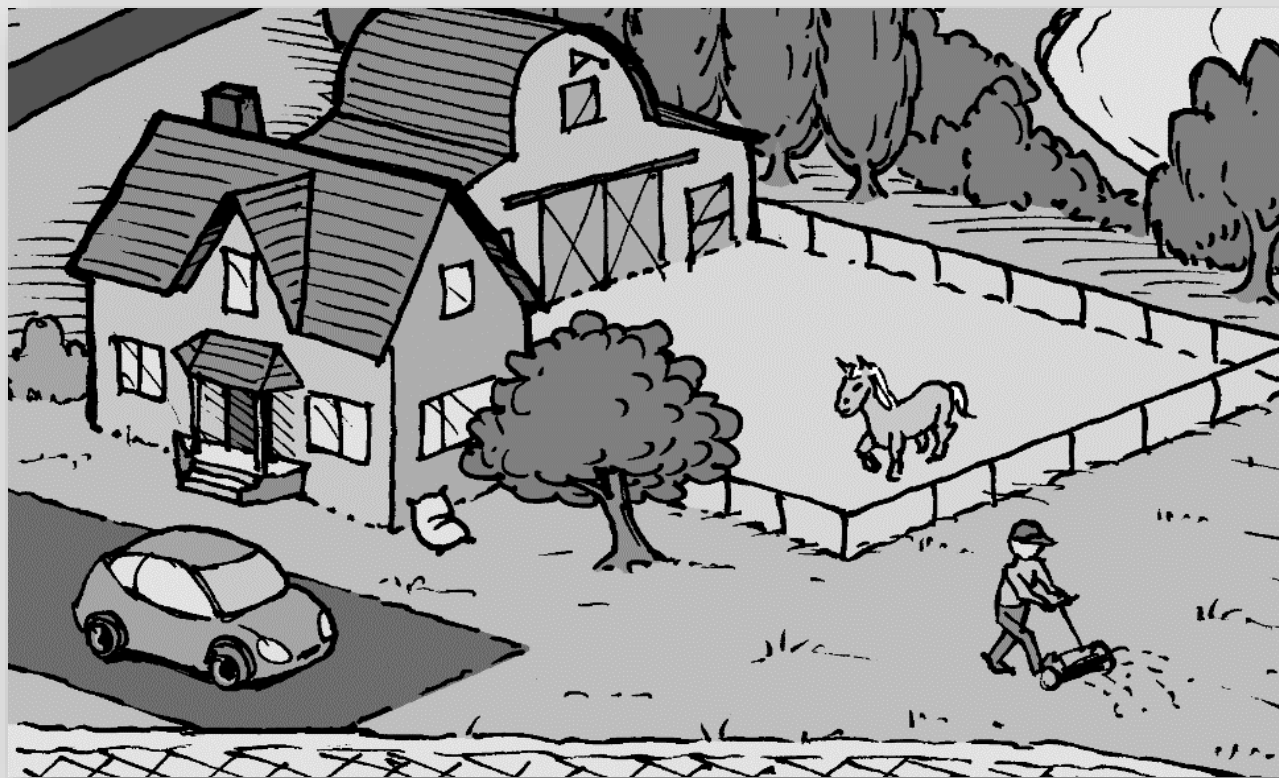

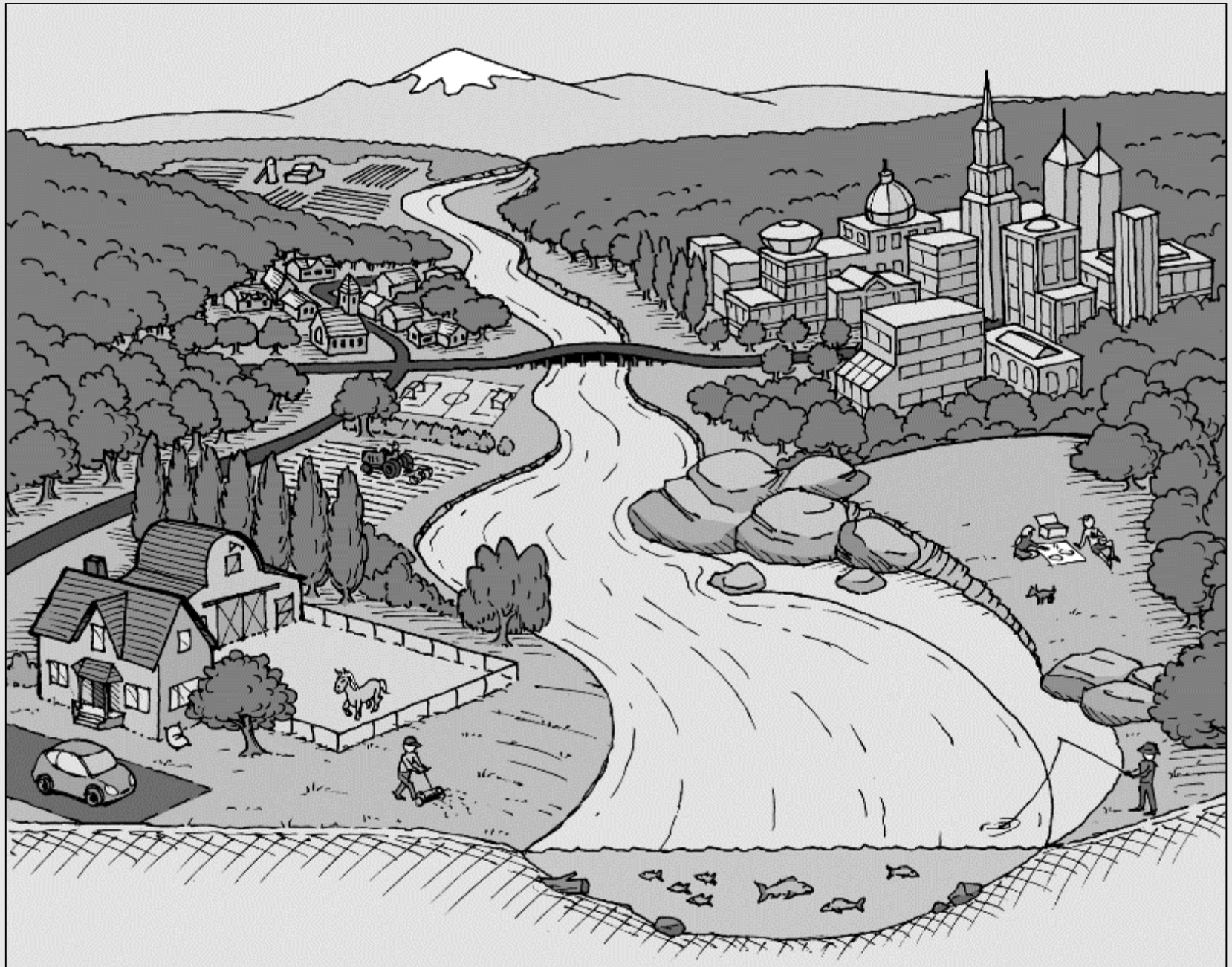





“Never doubt that a small group of thoughtful, committed citizens can change the world; indeed, it's the only thing that ever has.”

- Margaret Mead,  
American  
anthropologist

# Resources to follow up with:

- HCW speaker, develop materials
- HCW email list & newsletter
- HCW website with tip sheets – *[horsesforcleanwater.com](http://horsesforcleanwater.com)*
- HCW Face Book
- Sweet Pepper Ranch* – lessons, clinics, Cowgirl Retreats, training





# Contact:

- Alayne Blickle, Horses for Clean Water,  
206-909-0225,  
[alayne@horsesforcleanwater.com](mailto:alayne@horsesforcleanwater.com)



# The End(s)

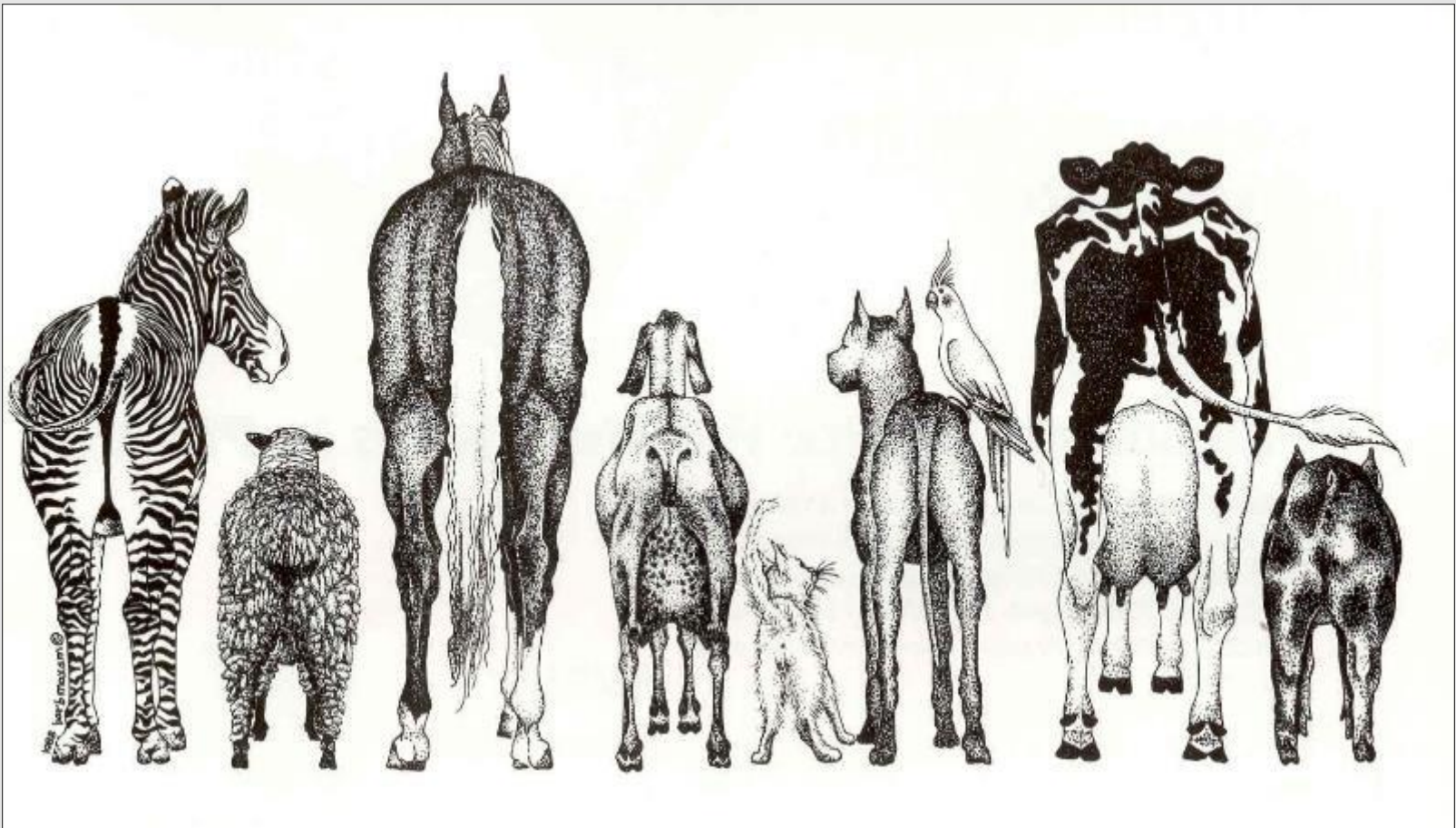

[www.horsesforcleanwater.com](http://www.horsesforcleanwater.com)